

MODEL: 011223-FINISH

WALL-HUNG COLLECTION

Soft Close Wood doors

Soft Close and Full Extension drawers with Dovetail Construction

Matching Finish throughout the Interior

Extend design with Optional 12", 15" & 18" Drawer Bridge and 15" Shelf Bridge

Matching Mirror, Medicine Cabinet and Wall Cabinet

All Ronbow cabinets are made of solid hardwood or hardwood plywood and meet strict CARB Standards.
No particle Board or Micro-Density Fiberboard (MDF) are used.

Available finishes:

DARK CHERRY H01

CINNAMON F08

WHITE W01

Available tops:

CERAMIC SINKTOP

GLASS SINKTOP

TECHSTONE™ TOP

WIDEAPPEAL™ TOP

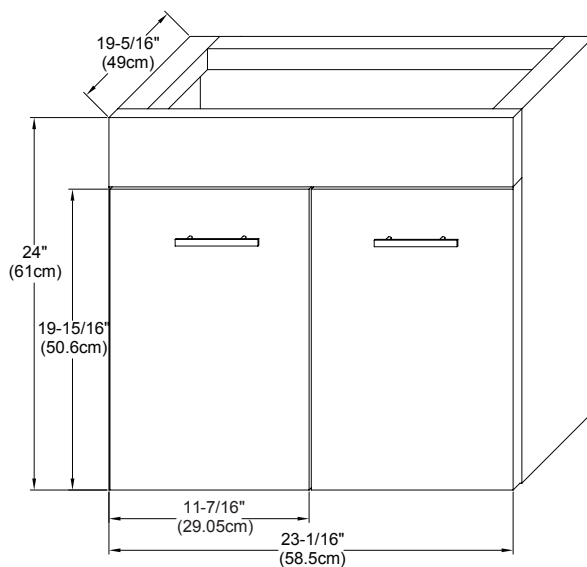

MODEL: 011231-L-FINISH
011231-R-FINISH

WALL-HUNG COLLECTION

Soft Close Wood doors
Soft Close and Full Extension drawers with Dovetail Construction
Matching Finish throughout the Interior
Extend design with Optional 12", 15" & 18" Drawer Bridge and 15" Shelf Bridge
Matching Mirror, Medicine Cabinet and Wall Cabinet
Door can be left (L) or right (R) side

All Ronbow cabinets are made of solid hardwood or hardwood plywood and meet strict CARB Standards.
No particle Board or Micro-Density Fiberboard (MDF) are used.

Available finishes:

DARK CHERRY H01

CINNAMON F08

WHITE W01

Available tops:

GLASS SINKTOP

CERAMIC SINKTOP

TECHSTONE™ TOP

WIDEAPPEAL™ TOP

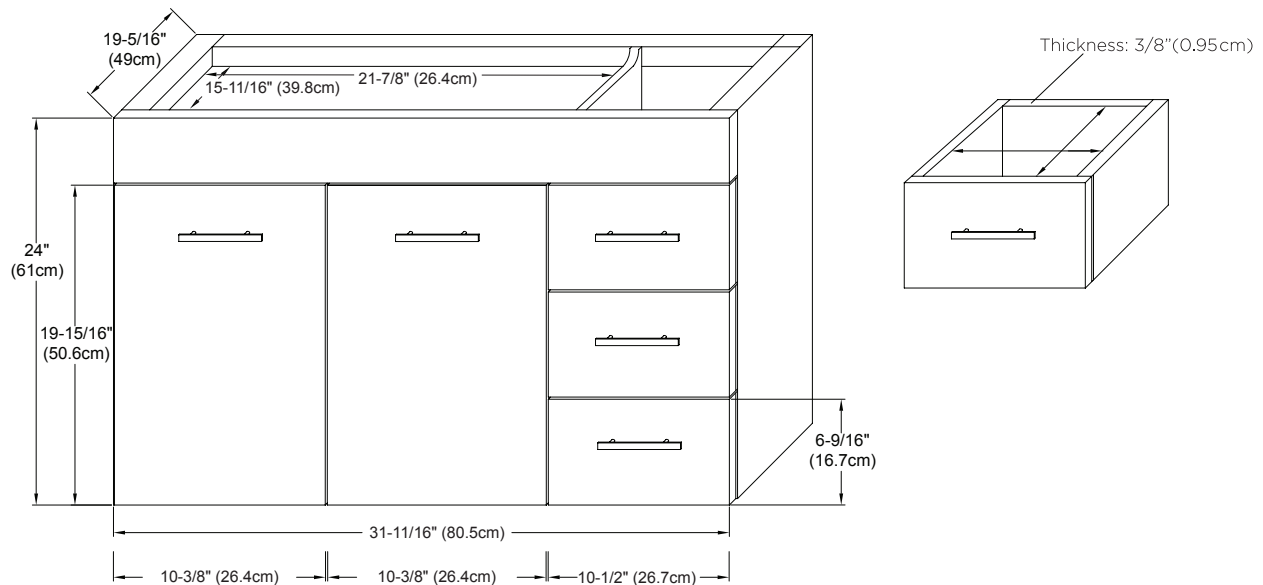

MODEL: 011236-L-FINISH
011236-R-FINISH

WALL-HUNG COLLECTION

Soft Close Wood doors

Soft Close and Full Extension drawers with Dovetail Construction

Matching Finish throughout the Interior

Extend design with Optional 12", 15" & 18" Drawer Bridge and 15" Shelf Bridge

Matching Mirror, Medicine Cabinet and Wall Cabinet

Door can be left (L) or right (R) side

All Ronbow cabinets are made of solid hardwood or hardwood plywood and meet strict CARB Standards.

No particle Board or Micro-Density Fiberboard (MDF) are used.

Available finishes:

DARK CHERRY H01

CINNAMON F08

WHITE W01

Available tops:

GLASS SINKTOP

CERAMIC SINKTOP

TECHSTONE™ TOP

WIDEAPPEAL™ TOP

