

FLATIRON MUS-5025



• FEATURES

16 gauge type 304 stainless steel

• TECHNICAL INFORMATION

External dimensions (L x W x D): 23" x 17" x 5-1/2"

Basin dimensions (L x W x D): 21" x 15" x 5-1/2"

• FINISHES

Brushed stainless steel (B)

• INSTALLATION OPTIONS

Under-mount

Top-mount

• MINIMUM CABINET SIZE

Under-mount 25"

Top-mount 24"

- All Mila sinks can be made to comply with ADA specifications.
- Custom ADA compliant sinks are available, please contact us directly.

• ACCESSORY OPTIONS

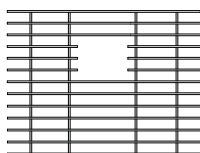

MBG-054
Basin Grid

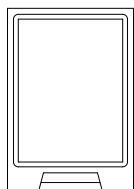

MCB-501
Cutting Board

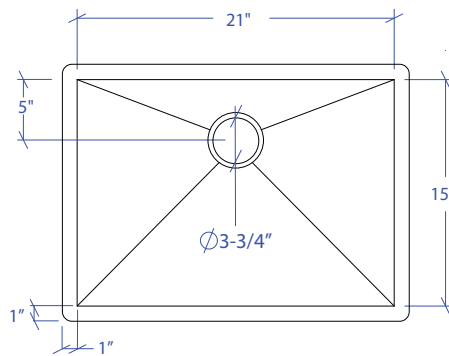
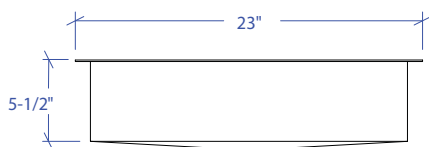

ADA UNDER-MOUNT