

ATELIER MTB-501S BRUSHED FINISH

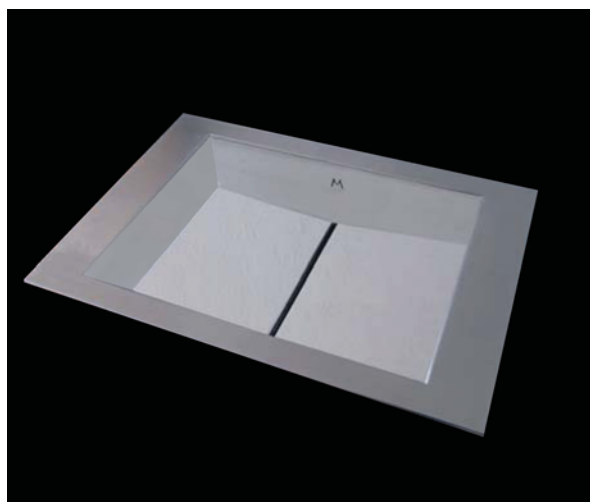

*Flush-Mount Installation Kit required for installation.

• FEATURES

16 gauge type 304 stainless steel
Tri-mount™ installation system
*FLUSH - MOUNTABLE

• TECHNICAL INFORMATION

External dimensions (L x W x D): 21" x 17" x 4"
Basin dimensions (L x W x D): 15" x 13" x 4"
Frame width: 2" / 3"
Frame thickness: 1/4"

• FINISHES

Frame: Brushed Stainless Steel (B)
Basin: Brushed Stainless Steel (B)

• INSTALLATION OPTIONS

Flush-mount (MTK-110 is required)
Top-mount
Under-mount

• MINIMUM CABINET SIZE (I.D.)

Flush-mount	23"
Top-mount	22"
Under-mount	23"

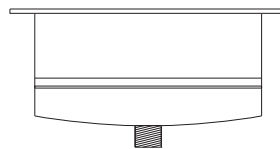
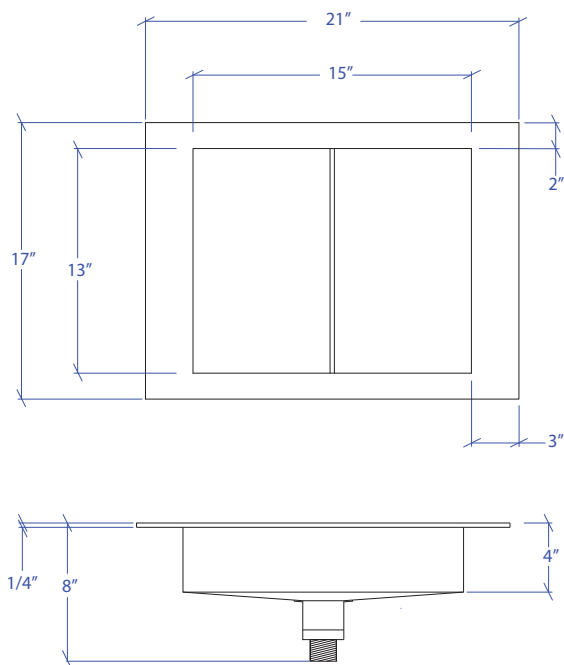

BATHROOM TRI-MOUNT™