

GENERAL SPECIFICATIONS:

Tub Size	73.125" x 34" x 22.5"
Bathing Well	length: 60.5" top / 49" bottom width: 29.625" top / 25.25" bottom depth at overflow: 17.5"
Soaker Weight	335 lbs / 152 kg
Maximum Fill	95 gal to overflow
Undermountable	No

CSA Certified C/US; NAHB Certified; ANSI Z124.1.

NOTE: Filling this tub to the maximum may require an above average size or dedicated water heater.

NOTE: Not recommended as a tub / shower combination.

Eryx Freestanding MTCT-138A 73.125" x 34" x 22.5"

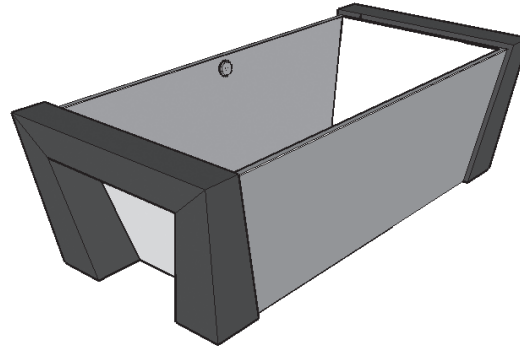

Freestanding Tub

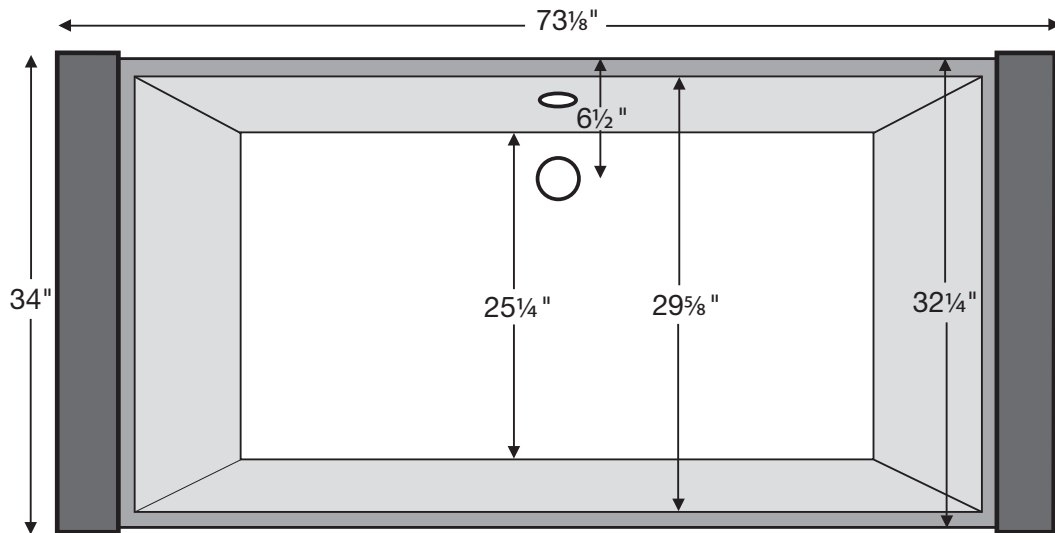

Most MTI freestanding solid-surface tubs use wall-mounted or freestanding faucets.

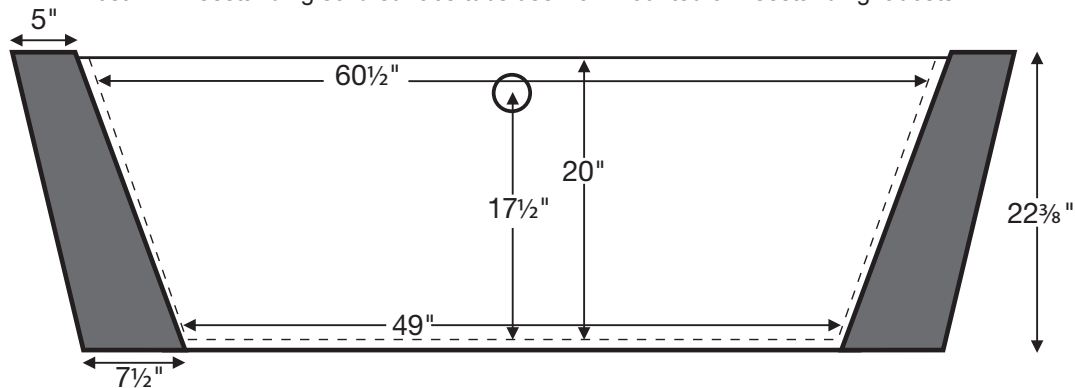

Measurements are $\pm 1/2"$ and are subject to change without notice.
Data herein supersedes all previous prior to publication date shown below.

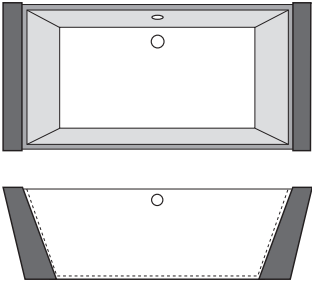

Eryx Freestanding MTCT-138A
73.125" x 34" x 22.5"

Soaker	Soaker (S138A)	
	Soaker with cherry wood surround and exposed square Toe-Tap drain kit included in Chrome	
	\$12,999	

COLORS

Standard: White or Biscuit, matte finish
Optional: White or Biscuit, gloss finish
 Osprey or Raven Granite, gloss finish
 Additional Colors available for projects only. Please call.

OPTIONS

- Quick Ship/Priority (QSPRI)
 - Eryx Cherry Wood Surround
 - Choose from the following finishes, which co-ordinate with MTI hand-crafted bath furniture (see Section J):

Silver Fern	Medium Walnut Stain
Rivera Cream	Ebony Stain
Antique Black	Dark Walnut Stain
Powder White	Tavern Red
Fossil	Drift Wood
- (**Note:** Surround can be finished to match any Benjamin Moore color available. Please specify model number of paint when placing order)
- Waste & Overflow Kits (For other available finishes see p C-1)

Solid-Surface Overflow Chrome (DKMQC)	STD
Solid-Surface Overflow Brushed Nickel Upcharge (DKMQBN)	\$75
Solid Surface Overflow Special Finish Upcharge (DKMQSF)	\$500
 - Pillows (see p C-12)

Soft "Jelly Bean" Pillow (PIJB)	\$100
Lounge Pillow (PIL)	\$116

N/C
 add \$1,020
 add \$1,199

N/A
 STD

STD
 \$75
 \$500
 \$100
 \$116

