

# ATELIER MTD-803



\*Flush-Mount Installation Kit required for installation.

## • FEATURES

16 gauge type 304 stainless steel  
Tri-mount™ installation system  
\*FLUSH - MOUNTABLE

## • TECHNICAL INFORMATION

External dimensions (L x W x D): 34" x 21" x 10"  
Basin dimensions (L x W x D): Left 17" x 18" x 10"/Right 13" x 18" x 10"  
Frame width: 1-1/2"  
Frame thickness: 1/4"

## • FINISHES

Brushed stainless steel (B)

## • INSTALLATION OPTIONS

Flush-mount (MTK-112 is required)  
Top-mount  
Under-mount

## • MINIMUM CABINET SIZE (I.D.)

Flush-mount	36"
Top-mount	35"
Under-mount	36"

## • ACCESSORY OPTIONS

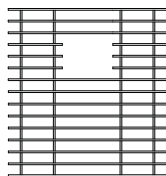

MBG-083  
Basin Grid

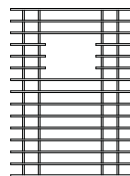

MBG-082  
Basin Grid

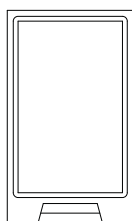

MCB-801  
Cutting Board

## • INDUSTRY'S ONLY STAINLESS STEEL SINK DESIGNED SPECIFICALLY TO BE FLUSH-MOUNTED

## • PATENT PENDING

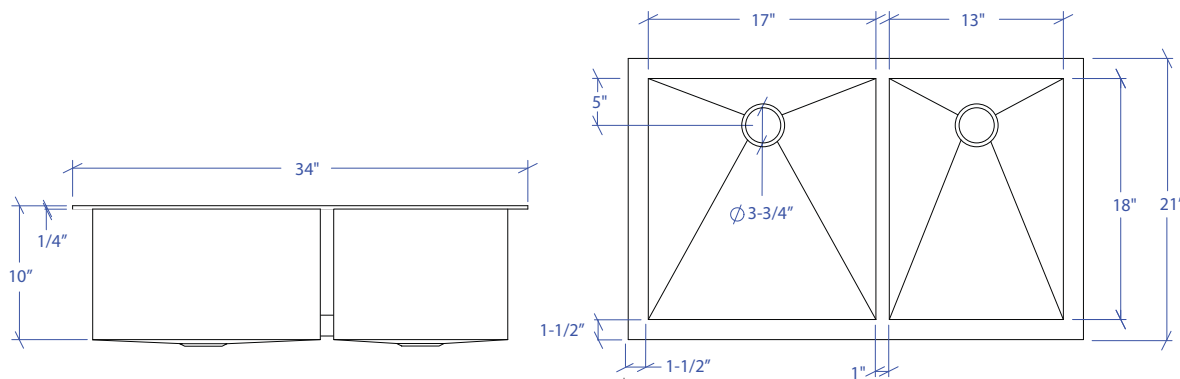

TRI-MOUNT™