

## GENERAL SPECIFICATIONS:

<b>Tub Size</b>	52" x 52" x 35.5"
<b>Bathing Well</b>	length: 45" top / 26" bottom width: 45" top / 34" bottom depth at overflow: 30"
<b>Soaker Weight</b>	135 lbs / 61.23 kg
<b>Maximum Fill</b>	160 gal to overflow
<b>Undermountable</b>	No

NOTE: Filling this tub to the maximum may require an above average size or dedicated water heater.

NOTE: Not recommended as a tub / shower combination.

## ELECTRICAL SPECIFICATIONS:

<b>Required Electrical Service</b>	110 Volt
<b>Air Bath</b>	1-15 amp GFCI

CSA Certified C/US; NAHB Certified; ANSI Z124.1 for plastic tubs and ANSI 112.19.7 for whirlpool components.

NOTE: See electrical specifications page for electrical requirements of options.

# Yume MTDS-134

52" x 52" x 35.5"



Freestanding Tub

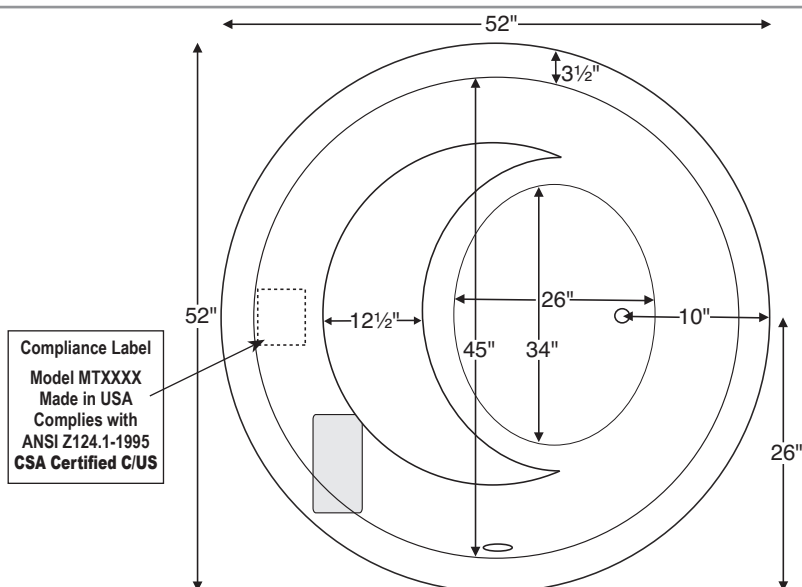

**IMPORTANT:**  
Must have access  
to the drain from  
underneath the  
tub for installation  
and servicing.

All MTI freestanding tubs use wall-mounted or freestanding faucets. The waste and overflow assembly is concealed between the walls of the tub, eliminating the need for a decorative exposed drain kit.

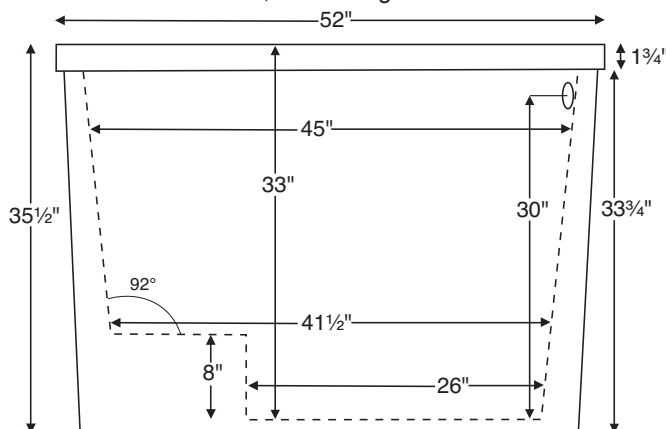

Before ordering  
or installing,  
please consider  
future access  
to equipment.

### INSTALLATION: MUST HAVE ACCESS TO THE DRAIN FROM UNDERNEATH THE TUB FOR INSTALLATION AND SERVICING.

Measurements are  $\pm 1/2"$  and are subject to change without notice. Data herein supersedes all previous prior to publication date shown below.

Tubs with more than one pump or blower will require additional service access.



# Yume MTDS-134

52" x 52" x 35.5"

All packages with air bath include a timer for added safety..

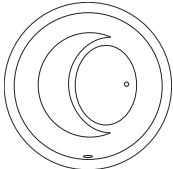
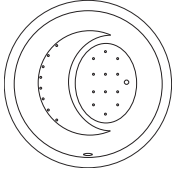
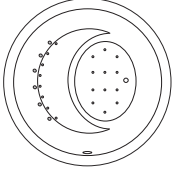
Soaker	Soaker (S134)		<b>IMPORTANT:</b> This tub will come standard with the overflow pre-installed at the factory. Drain is included with the tub for on-site installation. Specify type (Lift & Turn or Toe-Tap) and select finish from those listed below. Must specify at the time of ordering. Price of Drain & Overflow is included in the prices of the tubs to the left.  <b>IMPORTANT:</b> Must have access to the drain from underneath the tub for installation and servicing.
	Soaker with textured bottom and internal pre-levleed foam base		
	<b>\$4,940</b>		
System Aria	Air Bath (AST134)		
	20 air jets, heated blower, textured bottom and internal pre-levleed foam base		
	<b>\$6,945</b>		
System Aria Elite	Aria Elite Bath (AE134)		
	20 air jets, six 7-port lateral jets (42 air streams), heated blower, 2 LED lights, textured bottom and internal pre-levleed foam base		
	<b>\$8,583</b>		

## COLORS

**Standard:** White ONLY

**Color Upgrade:** See p M-1 for available colors

## OPTIONS FOR ALL BATHS (See Section C for details)

• Quick Ship/Priority. Call for availability. (QSPRI)	\$260
• Remote Control (REMOTE) (Air Bath packages only)	\$295
• Radiance® (RAD100) (See p C-23)	\$999
• Stereo H2O® with 2 transducers (STEREOH2O2) (See p C-20)	\$1559
• Virtual Spout (FPMJ) (See p C-25)	N/A
• Inline Heater Installed / Soaker and Air Bath (HTISOAK)	N/A
• Tub Shield Frameless Enclosure Chrome	N/A
Square Hinges (MXSH24C) Oval Hinges (QXSH24C)	N/A
Other finishes available (See p K-13)	N/A
• Acrylic Grab Bars, Curved 9" (set of 2)	N/A
White (GBCW); Bone (GBCB); Almond (GBCAL); Biscuit (GBCBS); Clear w/ Chrome Accents (GBCAC)	
Clear w/ Brass Accents (GBCBAC)	
Clear w/ Brushed Nickel Accents (GBCAB)	
• Metal Grab Bars, Modern Straight 9" (set of 2)	N/A
Chrome (GBMS9C); Brushed Nickel (GBMS9BN)	
Polished Nickel (GBMS9PN)	
• Metal Grab Bars, Curved 9" (set of 2)	N/A
Chrome (GBMCC); Brushed Nickel (GBMCCBN); Polished Nickel (GBMCPN)	
• Waste & Overflow Kits (For other available finishes see p C-1)	
Lift & Turn White (WOW)	STD
Lift & Turn Chrome (WOC)	STD
Lift & Turn Brushed Nickel (WOBN)	STD
Cable Driven White, Bone, Biscuit, Almond (WOCDW)	N/A
Cable Driven Chrome (WOCDB)	N/A
Cable Driven Brass (WOCDBR)	N/A
Cable Driven Oil Rubbed Bronze (WOCDOB)	N/A
Cable Driven Brushed Nickel (WOCDBN)	N/A
Cable Driven Polished Nickel (WOCDBPN)	N/A
Toe-Tap Chrome (WOTTC)	STD
Toe-Tap Brushed Nickel (WOTTCBN)	STD
• Decorative Towel Bar Chrome (CHTOWEL)	N/A
• Decorative Towel Bar Brushed Nickel (BNTOWEL)	N/A
• Blower Box: Oak (BBOAK); Cherry (BBCH); Maple (BBMAP)	\$616
• Textured Non-Slip Bottom (TXTBTM) meets ASTM F-462-1994	STD
• Chromatherapy: digitally controlled LED lighting (LE)	\$499
• Pillows: various shapes and sizes	See p C-12
• Hand-Held Showers, factory-installed	N/A

- Integral Tile Flange 3 sides (ITF) Specify RH or LH Drain
- Tile Flange Kit Factory-Installed 3 sides – Rigid ABS (TFK3)
- Tile Flange Kit Field-Installed 3 sides – Rigid ABS (TFKNI)
- Pre-Leveled Foam Base (PLFOAM)
- Pre-Leveled Frame and Foam Base (PLF)
- Skirting w/Tub
  - Paintable Wood Skirt (SKW6)
  - Stainable Wood Skirt / Cherry (SKCH6)
  - Stainable Wood Skirt / Oak or Maple (SKO6)
  - One-Piece Traditional Acrylic Raised Panel (SKAO6)
  - Acrylic Raised Panel-Look w/ Removable Panels (SKAR6)
  - One-Piece Contemporary Acrylic Flat Panel (SKFO6)
  - Acrylic Euro-Style w/ Removable Panels (SKE6)
  - Acrylic Skirting Color Upgrade (See p M-1)

N/A  
N/A  
N/A  
STD  
N/A  
N/A  
N/A  
N/A  
N/A  
N/A  
N/A  
N/A

